



FC258

**SOLICE LONGFIELD AVENUE, ST. BRELADE, JERSEY,  
JE3 8EB**

Asking Price

**£5,850,000**

**FINE & COUNTRY**  
JERSEY

## Property details

SOLE AGENT - An exceptional, newly built luxury residence of approximately 5,000 sq. ft., offering five en-suite bedrooms and impeccably finished contemporary interiors. This high-specification home enjoys outstanding, elevated views over the stunning bay of St. Brelade.

The property benefits from an integral double garage with additional driveway parking, low-maintenance landscaped outdoor areas at ground level, and a generous roof terrace accessed from the principal suite, perfectly positioned to take in the spectacular coastal outlook.

Situated on a private cul-de-sac in sought-after St. Brelade, the location offers convenient access to the airport, La Moye Golf Club, the golden sands of St. Brelade's Bay, and local amenities including Waitrose.

Completion anticipated end of 2025.

## Outside

## Services

## Directions





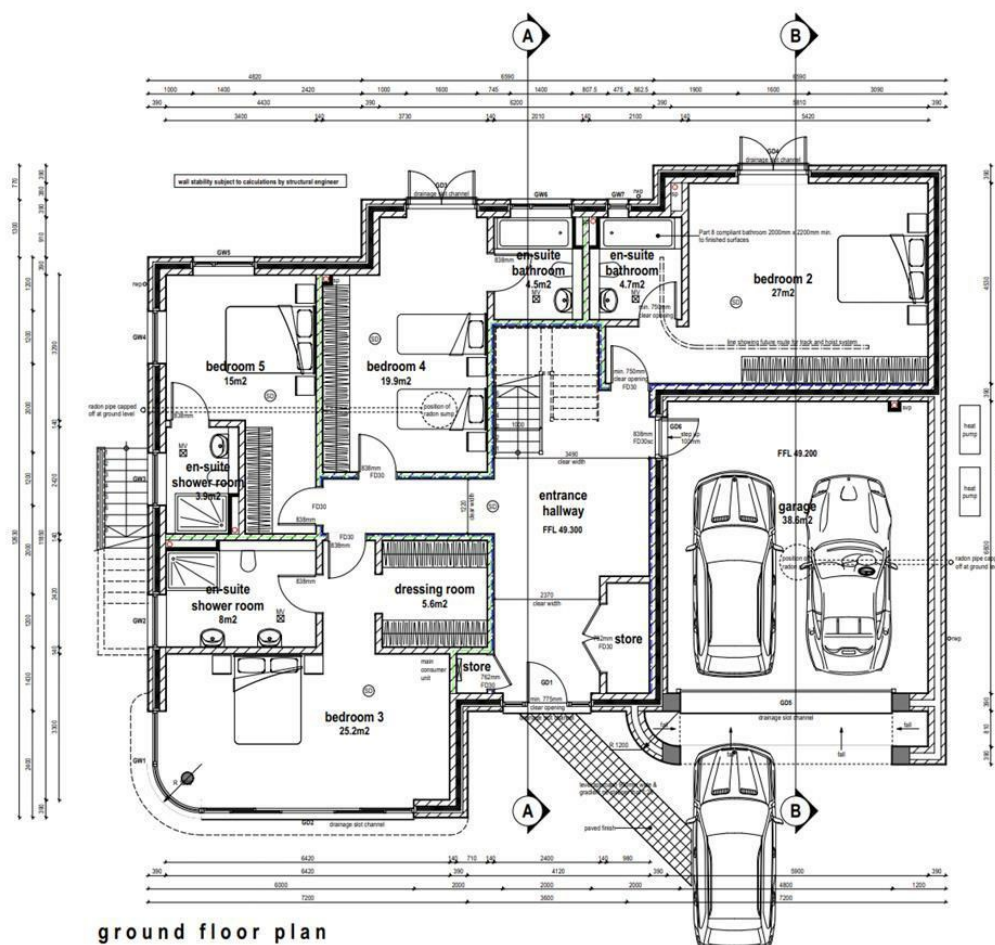

ground floor plan

Call us on

**01534 888855**

[jersey@fineandcountry.com](mailto:jersey@fineandcountry.com)

[www.fineandcountry.je](http://www.fineandcountry.je)

**5 King Street, St Helier, Jersey, JE2 4WF**

MONEY LAUNDERING REGULATION - Once an offer is accepted and negotiations for the purchase of a property are entered into, the prospective purchasers will be asked to produce photographic identification and proof of residency documentation, e.g. current utility bill and ID. This is in order for us to comply with the current Money Laundering Legislation.

Fine & Country Jersey advises prospective purchasers that we have prepared these sales particulars as a general guide only. We have not carried out a detailed survey, nor tested the services, appliances and specified fittings. Room sizes are approximate and rounded; they are taken between internal wall surfaces and therefore include cupboards/shelves etc, accordingly they should not be relied upon when purchasing fittings. Carpet, curtains/blinds and kitchen equipment, whether fitted or not, are deemed to be removable by the vendor unless specifically itemised within these particulars and/or within the property inventory. These particulars are supplied on the understanding that all negotiations are conducted through Fine & Country Jersey, their accuracy is not guaranteed nor do they form part of any contract.